

Δ						
Δ						
Δ						

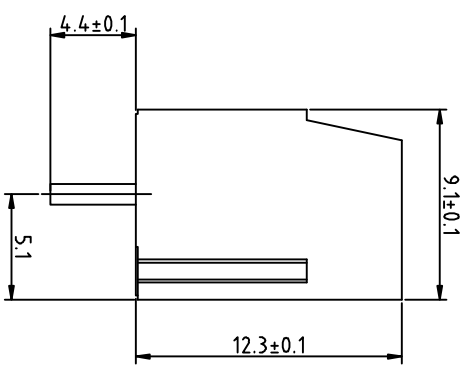
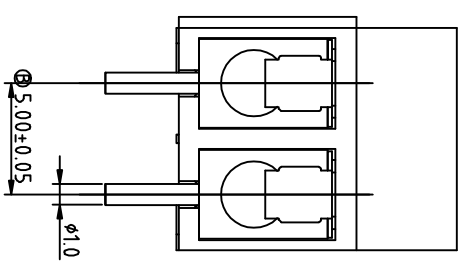
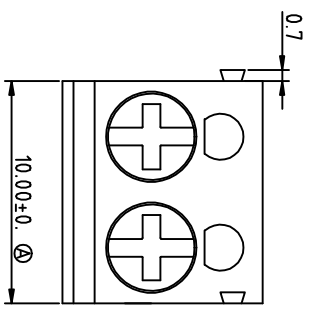

Technical Data:

Material:

- Contact(metal housing): Brass (CuZn)
- Terminal screw: Steel galvanized and chromateize or Nickel plated or Tin plated(standard)(optian)
- Wire guard: Stainless steel
- Surface of solder tail: tin plated
- Insulator body(housing): Polyamide(Glass filled)(UL_94V-0)

Electrical

- Voltage rating: 250VAC
- Current rating: 16 Amps/way max
- Contact resistance: 20m (max)
- Insulation resistance: 5000M /4900V
- Withstanding Voltage: 1500VAC(1min) Test time=60sec/1pcs
- Wire range: 14-22AWG

Mechanical:

- Torque: 4kg-cm/M3
- Operating temperature: -33°C to +120°C
- Soldering ability: 95%coveragel/min)
- Test temperature= 230°C±10°C
- Test time= 4sec±0.5sec
- Soldering reliability:
 - Test temperature= 250°C±10°C
 - 5 seconds max

Safety approval detra: 

POLE	2P	
A	NX5.0	10.0
B	(N-1) X5.0	5.0



杰科电子有限公司
JIE KE ELECTRONICS CO., LTD.

PART NAME: JK300-500 2P

TITLE:

PART NO.:

DWG NAME: TA0002B1DWG

APPROVED BY

CHECKED BY

DESIGNED BY

DRAWN BY

CUSTOM NO.:

UNITS: mm

Tolerance

安杰

孙学丰



SCALE: 4/1

X.X ±0.50
X.XX ±0.30
X.XX ±0.10
XX ±1°

安杰

孙学丰



SCALE: 4/1

X.X ±0.50
X.XX ±0.30
X.XX ±0.10
XX ±1°

REVISION: B1